

Instruction manual

# 200W 3in1 Sander

CPO3IN1 (DY94281)



ORIGINAL INSTRUCTIONS

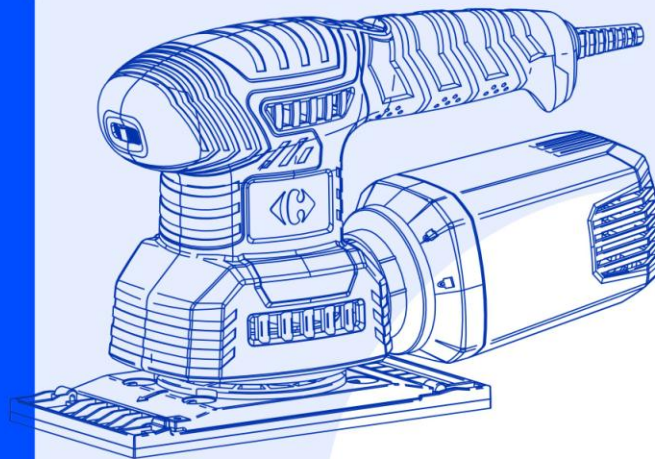



**Congratulation on your purchase.**

**The quality team at CARREFOUR cares for its products to meet conformity and performances.**

**Paying close attention to your satisfaction, our experts work all day on the improvement of our products.**



For assembly and/or maintenance and/or use of your product, you can use:



These products are available in CARREFOUR stores.



## **Read this manual carefully**

For a better use of your new device, we recommend you to read carefully this Instruction Manual and keep it for record.

Keep it carefully for future reference.





Please also find information about the scraping of the product in this Instruction Manual.



## **Safety instructions**

Before installing or using this product, please read carefully the safety measures after the table of contents.

## Pictograms used

	Warning symbols with information on damage and injury prevention.
	Read the instruction manual.
	Electrical products must not be disposed of with the domestic waste.
	Protection class II (double insulation)

## CONTENTS

---

<b>SAFETY INSTRUCTIONS .....</b>	<b>4</b>
<b>PRODUCT DESCRIPTION .....</b>	<b>7</b>
<b>INTENDED USE.....</b>	<b>10</b>
<b>SCOPE OF DELIVERY .....</b>	<b>11</b>
<b>ASSEMBLY .....</b>	<b>11</b>
<b>OPERATION .....</b>	<b>13</b>
<b>CLEANING &amp; MAINTENANCE .....</b>	<b>14</b>
<b>STORAGE AND TRANSPORTATION .....</b>	<b>14</b>
<b>REPLACEMENT PARTS /ACCESSORIES .....</b>	<b>14</b>
<b>TROUBLESHOOTING .....</b>	<b>14</b>
<b>DISPOSAL .....</b>	<b>15</b>
<b>DECLARATION OF CONFORMITY .....</b>	<b>16</b>
<b>WARRANTY .....</b>	<b>17</b>
<b>PRODUCT FAILURE.....</b>	<b>18</b>
<b>WARRANTY EXCLUSIONS .....</b>	<b>19</b>

# SAFETY INSTRUCTIONS

---

## **GENERAL POWER TOOL SAFETY WARNINGS**

**WARNING** Read all safety warnings, instructions, illustrations and specifications provided with this power tool. Failure to follow all instructions listed below may result in electric shock, fire and/or serious injury.

**Save all warnings and instructions for future reference.**

The term "power tool" in the warnings refers to your mains-operated (corded) power tool or battery-operated(cordless) power tool.

### **1. Work area safety**

- a) **Keep work area clean and well lit.** Cluttered or dark areas invite accidents.
- b) **Do not operate power tools in explosive atmospheres, such as in the presence of flammable liquids, gases or dust.** Power tools create sparks which may ignite the dust or fumes.
- c) **Keep children and bystanders away while operating a power tool.** Distractions can cause you to lose control.

### **2. Electrical safety**

- a) **Power tool plugs must match the outlet. Never modify the plug in any way. Do not use any adapter plugs with earthed (grounded) power tools.** Unmodified plugs and matching outlets will reduce risk of electric shock.
- b) **Avoid body contact with earthed or grounded surfaces, such as pipes, radiators, ranges and refrigerators.** There is an increased risk of electric shock if your body is earthed or grounded.
- c) **Do not expose power tools to rain or wet conditions.** Water entering a power tool will increase the risk of electric shock.
- d) **Do not abuse the cord. Never use the cord for carrying, pulling or unplugging the power tool. Keep cord away from heat, oil, sharp edges or moving parts.** Damaged or entangled cords increase the risk of electric shock.
- e) **When operating a power tool outdoors, use an extension cord suitable for outdoor use.** Use of a cord suitable for outdoor use reduces the risk of electric shock.
- f) **If operating a power tool in a damp location is unavoidable, use a residual current device (RCD) protected supply.** Use of an RCD reduces the risk of electric shock.

### **3. Personal safety**

- a) **Stay alert, watch what you are doing and use common sense when operating a power tool. Do not use a power tool while you are tired or under the influence of drugs, alcohol or medication.** A moment of inattention while operating power tools may result in serious personal injury.
- b) **Use personal protective equipment. Always wear eye protection.** Protective equipment such as a dust mask, non-skid safety shoes, hard hat or hearing protection used for appropriate conditions will reduce personal injuries.
- c) **Prevent unintentional starting. Ensure the switch is in the off-position before connecting to power source and/or battery pack, picking up or carrying the tool.** Carrying power tools with your finger on the switch or energising power tools that have the switch on invites accidents.
- d) **Remove any adjusting key or wrench before turning the power tool on.** A wrench or a key left attached to a rotating part of the power tool may result in personal injury.
- e) **Do not overreach. Keep proper footing and balance at all times.** This enables better control of the power tool in unexpected situations.
- f) **Dress properly. Do not wear loose clothing or jewellery. Keep your hair and clothing away from moving parts.** Loose clothes, jewellery or long hair can be caught in moving parts.

g) If devices are provided for the connection of dust extraction and collection facilities, ensure these are connected and properly used. *Use of dust collection can reduce dust-related hazards.*

h) Do not let familiarity gained from frequent use of tools allow you to become complacent and ignore tool safety principles. *A careless action can cause severe injury within a fraction of a second.*

#### 4. Power tool use and care

a) Do not force the power tool. Use the correct power tool for your application. *The correct power tool will do the job better and safer at the rate for which it was designed.*

b) Do not use the power tool if the switch does not turn it on and off. *Any power tool that cannot be controlled with the switch is dangerous and must be repaired.*

c) Disconnect the plug from the power source and/or remove the battery pack, if detachable, from the power tool before making any adjustments, changing accessories, or storing power tools. *Such preventive safety measures reduce the risk of starting the power tool accidentally.*

d) Store idle power tools out of the reach of children and do not allow persons unfamiliar with the power tool or these instructions to operate the power tool. *Power tools are dangerous in the hands of untrained users.*

e) Maintain power tools and accessories. Check for misalignment or binding of moving parts, breakage of parts and any other condition that may affect the power tool's operation. If damaged, have the power tool repaired before use. *Many accidents are caused by poorly maintained power tools.*

f) Keep cutting tools sharp and clean. *Properly maintained cutting tools with sharp cutting edges are less likely to bind and are easier to control.*

g) Use the power tool, accessories and tool bits etc. in accordance with these instructions, taking into account the working conditions and the work to be performed. *Use of the power tool for operations different from those intended could result in a hazardous situation.*

h) Keep handles and grasping surfaces dry, clean and free from oil and grease. *Slippery handles and grasping surfaces do not allow for safe handling and control of the tool in unexpected situations.*

#### 5. Service

a) Have your power tool serviced by a qualified repair person using only identical replacement parts.

*This will ensure that the safety of the power tool is maintained.*

## **SANDER SAFETY WARNINGS**

Hold the power tool by insulated gripping surfaces, because the sanding surface may contact its own cord. *Cutting a "live" wire may make exposed metal parts of the power tool "live" and could give the operator an electric shock.*

## **SPECIFIC SAFETY INSTRUCTIONS FOR SANDER**

 **WARNING!** Sander can result in the formation of hazardous dusts (e.g. arising from materials such as paints containing lead, materials containing asbestos, metals or some wood types), which can present a health hazard to the operator or persons in the vicinity if touched or inhaled. Make sure that the workplace is well ventilated. Always wear safety goggles, safety gloves and respiratory protection. **Attach a dust extraction system.**

1. Secure the workpiece. A workpiece that is retained with clamping appliances or a vice is held more securely than with your hands.
2. Only use the power tool for dry sanding. Do not scrape moist materials. Penetration of water into the

- power tool increases the risk of electric shock.
3. Avoid overheating the sanded object and the sander itself. Possible fire hazard.
  4. The workpiece gets hot during grinding. Do not touch the machined area, allow it to cool down. There is a risk of burning. Do not use coolants or the like.
  5. Always empty the dust container before work breaks. Sanding dust in the dust sack, microfilter, paper sack (or in the filter sack or extraction system filter) can self-ignite under unfavourable conditions such as flying sparks caused by grinding metals. Particular hazards are caused if the sanding dust is mixed with paint, polyurethane residues or other chemical substances, or if the sanded object is hot after long working periods.
  6. Please check the operating manual of your vacuum cleaner whether it is suitable for the suction of grinding chips.
  7. Connect the appliance to a power socket with a residual current circuit breaker of rated residual current no more than 30mA.
  8. Type Y attachment, If the replacement of the supply cord is necessary, this has to be done by the manufacturer or his agent in order to avoid a safety hazard.

## **RESIDUAL RISK**

Even if properly operating and handling this electric tool, some residual risks will remain. Due to its construction and build, this electric tool may present the following hazards,

1. Lung damage, if suitable respiratory protection is not worn;
2. Cuts
3. Ear damage if working without wearing ear protection
4. Eye damage if suitable eyes protection is not worn.
5. Damage to your health caused by swinging your hands and arms when operating the electric tool for longer periods of time or if the too is not held or maintained properly

# PRODUCT DESCRIPTION

(Fig.A)

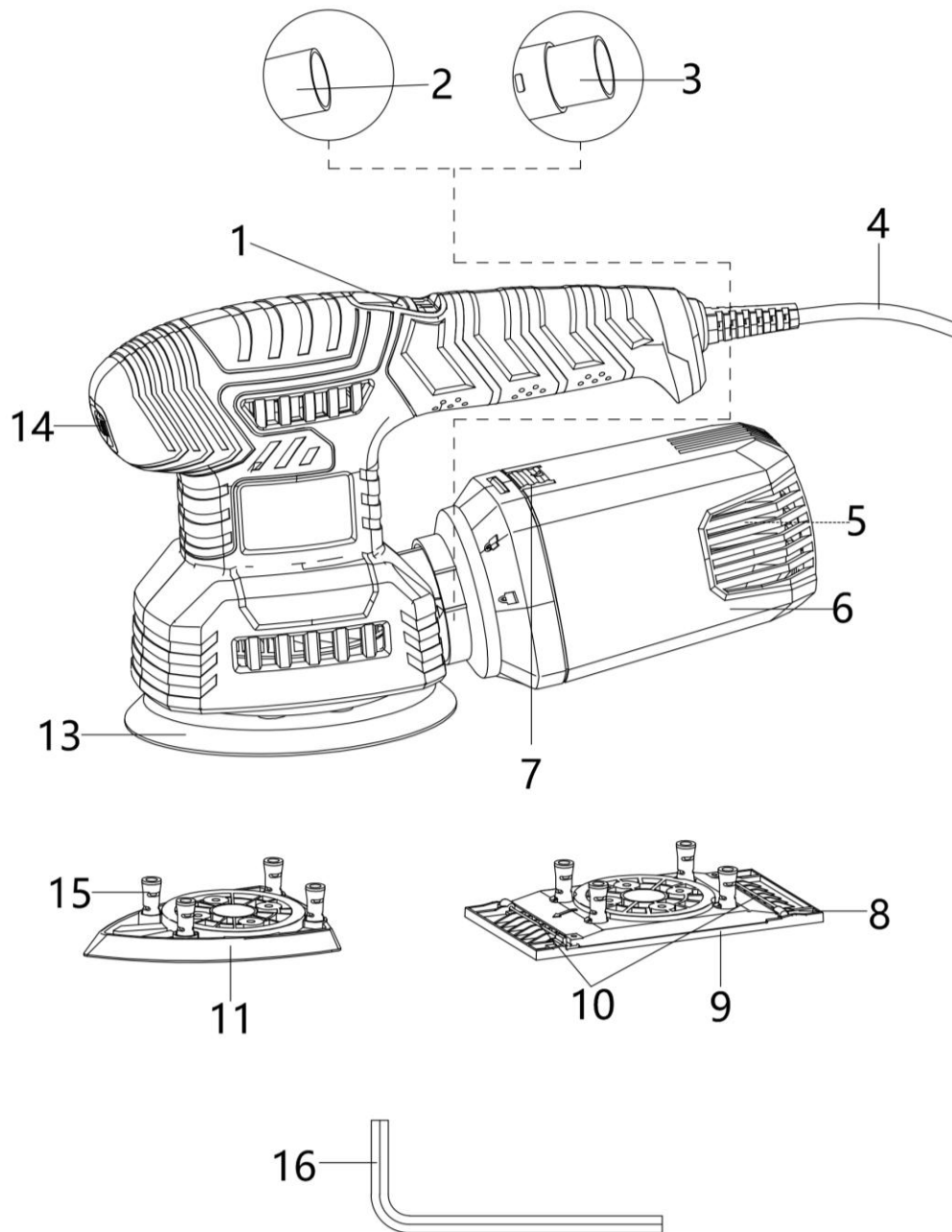

B

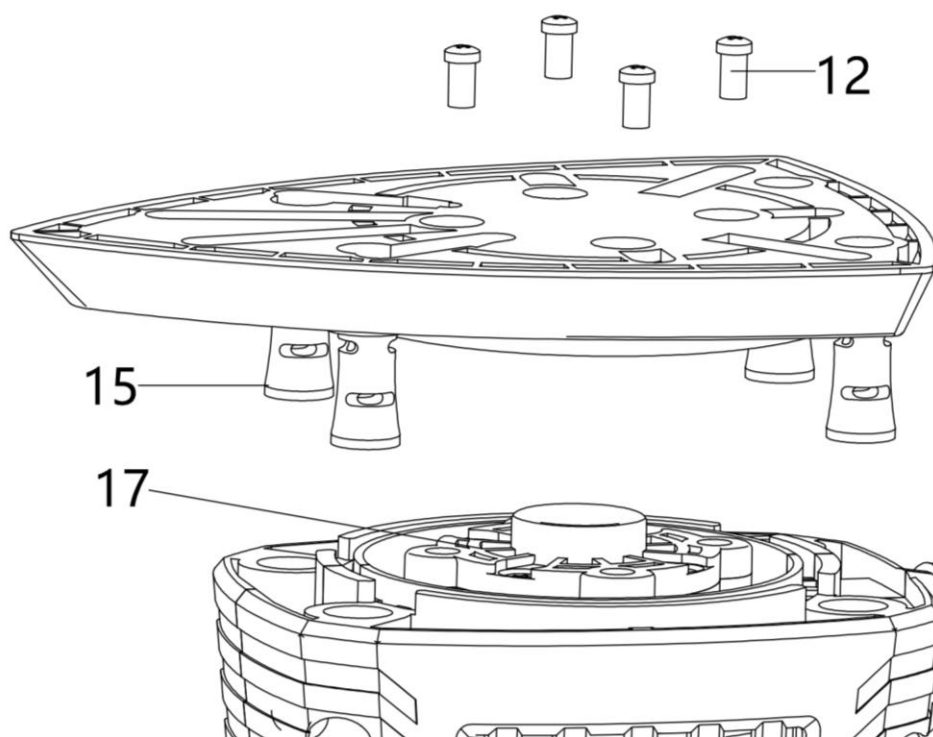

C

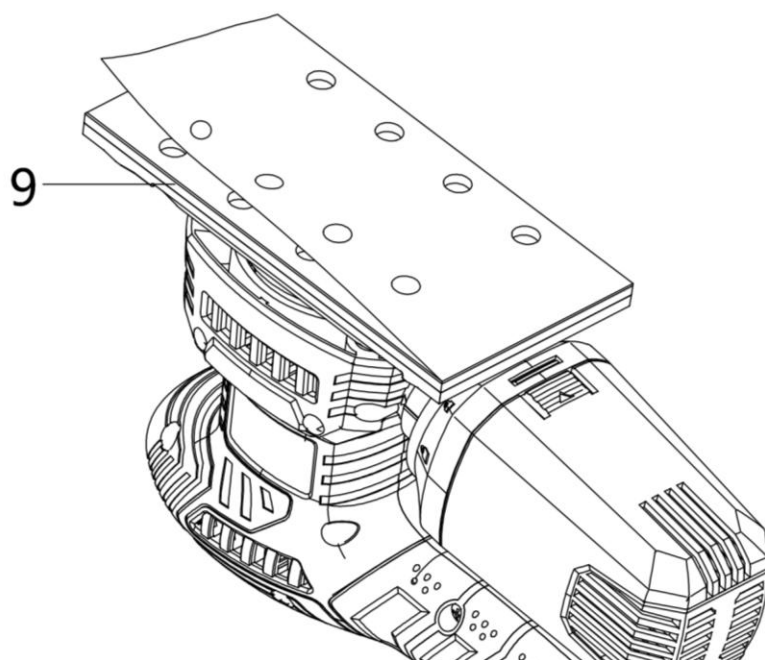



# D

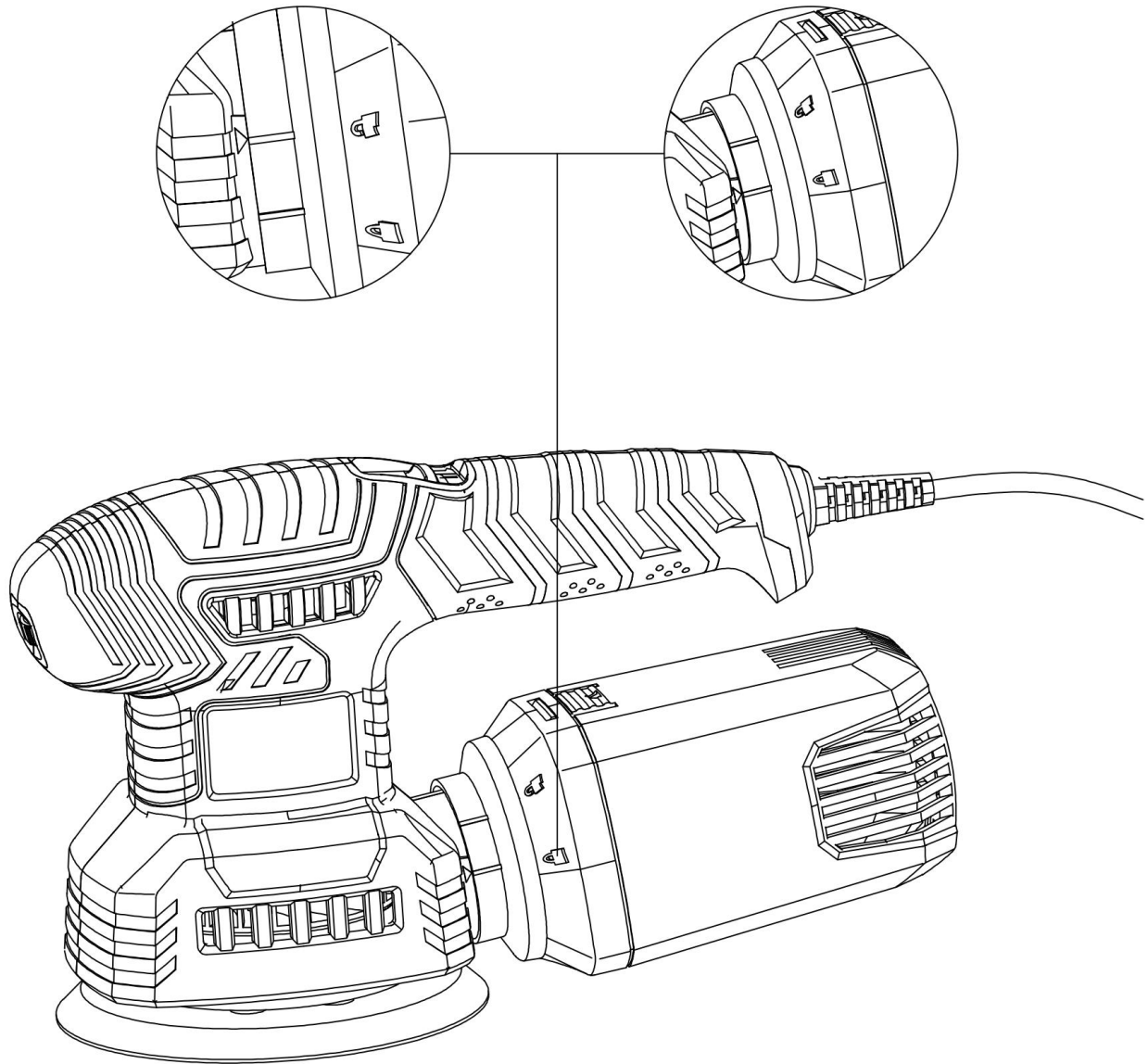

## OVERVIEW (Fig.A-B)

1. On/Off switch
2. Adapter fitting
3. Adapter for external extraction appliance
4. Mains cable
5. Dust bag
6. Dust collection box
7. Release button for dust box
8. Clamping levers
9. Orbital sander plate
10. Clamping rails
11. Delta sander plate
12. Screws (4x)
13. Eccentric sander plate
14. Speed selector
15. Rubber pin (4x)
16. Hex key
17. Mounting plate

## INTRODUCTION

The operating instructions contain important information on safety, use and disposal. It is essential that you read the instructions before assembling, operation and maintaining the product. Use the product only as described and for the applications specified. Keep this manual safely and in the event that the product is passed on, hand over all documents to the third party.

## TECHNICAL DATA

Rated voltage	230V~, 50Hz
Rated power	200W
Rated no-load/ $n_0$ :	7000-12000/min
Rated Oscillation rate:	14000-24000 /min
Degree of Protection:	IP20
Protection class:	II/ 
Weight (without sander disc and dust collection box)	1.38 kg
Noise emission value according to EN 62841-2-4	
Sound pressure level $L_{PA}$	81,0 dB(A)
Sound power level $L_{WA}$	91,0 dB(A)
Uncertainty K	3dB
Vibration emission value according to EN 62841-2-4	
Delta sander $a_h$	7,893 $m/s^2$
Eccentric sander $a_h$	10,007 $m/s^2$
Rotary sander $a_h$	9,530 $m/s^2$
Uncertainty K	1.5 $m/s^2$

- The declared vibration total values and the declared noise emission values have been measured in accordance with a standard test method and may be used for comparing one tool with another.
- The declared vibration total values and the declared noise emission values may also be used in a preliminary assessment of exposure.

### **WARNINGS**

- The vibration and noise emissions during actual use of the power tool can differ from the declared values depending on the ways in which the tool is used especially what kind of workpiece is processed; and
- It is necessary to identify safety measures to protect the operator that are based on an estimation of exposure in the actual conditions of use (taking account of all parts of the operating cycle such as the times when the tool is switched off and when it is running idle in addition to the trigger time).

## INTENDED USE

The 3-in-1 sander is intended for dry sanding of wood, metal, plastic, plaster and painted surfaces. The device is flexible and suitable for corners, edges and hard-to-reach areas. The sander is not suitable for commercial use.

The device is designed for use by adults. Adolescents over the age of 16 may use the device only under supervision. The manufacturer is not liable for damages caused by unspecified use or incorrect operation.

Any other use or modification that is not explicitly approved in these instructions may result in damage to the device and represent a serious danger to the user.

## SCOPE OF DELIVERY

---

- 1 x sander motor unit
- 1 x delta sander plate
- 1 x eccentric sander plate
- 1 x orbital sander plate
- 3 x sanding sheets (grain size P80)
- 1 x delta sanding sheet
- 1 x eccentric sanding sheet
- 1 x orbital sanding sheet
- 1 x dust collection box
- 1 x adapter for external dust extraction
- 4 x Screws (pre-assembled)
- 4 x Rubber pins (pre-assembled)
- 1 x instruction manual
- 1 x Hex key

## ASSEMBLY

---

 **WARNING!** Always disconnected with the plug from the mains socket before assembly and adjustment. Danger of electric shock!

### INSTALLING / CHANGING THE SANDER PLATE (FIG. B)

#### **NOTE:**

- **The appliance is delivered with the orbital sander plate (9) pre-assembled.**
  - **Removing the pre-assembled sander plate and position the mounting plate:**
  - **Use the appropriate sander plate (9) (11) (13) for the corresponding application.**
1. Remove the 4 x screws (12) with the supplied hex key (16).
  2. Remove the pre-assembled sander plate.
  3. Now fit the required sander plate. Ensure that the mounting plate is aligned with the sander plate. The threaded holes of the mounting plate (17) must be aligned with the corresponding holes on the respective sander plate. Align the rubber pins (15) with the holes in the appliance.
  4. Re-tighten the 4x screws (12) with the hex key (16).
  5. Check the sander plate is fitted securely.

### SELECTING A SANDING SHEET

#### **1. Removal and surface**

- The materials removal rate and the surface quality are determined by the grain strength of the sanding sheet.

- Please note that you need use the appropriate sanding sheet with different grains for working different materials.

## 2. Attaching/Removing sanding sheet

### Note:

- Clean the sander plate before you attach a sanding sheet.
- Use only appropriate sanding sheet sizes. Sanding sheets, which extend beyond the sander plate can cause injuries and can cause the sanding sheets to block or tear.

## 3. Attaching / removing the sanding sheet with Velcro (Fig. C)

The sanding disc are fitted with Velcro backing for quick mounting of sanding sheets.

- Press the desired sanding sheet evenly onto the sander plate (9/11/13). Ensure that the extraction holes on the sanding sheet match up with those on the sander plate.
- Simply pull the sanding sheet off the sander plate (9/11/13) to remove the sanding sheet.

## 4. Clamping /removing the sanding sheet without Velcro

The orbital sander plate (9) is equipped with clamping levers (8) for clamping sanding sheets without Velcro (sanding sheets not included)



- Open the two clamping levers (8) on the orbital sander disc (9).
- Push the sanding sheet under the open clamping rail (10) at one end and clamp it firmly in place with the clamping lever (8).
- Follow the same procedure at the other end.

## CONNECTING /REMOVING /EMPTYING THE DUST COLLECTION BOX (FIG.D)

### **WARNING! RISK OF FIRE!**

When working with power tools that have a dust collection box or can be connected to a vacuum cleaner via the vacuum cleaner adapter, there is a risk of fire! In unfavourable conditions, e.g. when sparks are flying while sanding metal or metal residues in wood, wood dust in the dust sack (or in the vacuum cleaner dust bag) can spontaneously ignite. This is a particular risk if the wood dust is mixed with paint residues or other chemicals and the workpiece has become hot after being worked for a long time. Therefore, do not allow the workpiece to overheat and always empty the dust box or the dust bag of the vacuum cleaner before taking a break from work.

### **WARNING! Wear a Dust Mask!**

1. Before connecting, ensure that the dust collection box (6) is firmly closed.
2. Slide the dust collection box (6) on the appliance. Make sure that the “” symbol on the dust box is aligned with the arrow symbol on the appliance. Turn the dust collection box (6) to the “” symbol to lock it.
3. Turn “” symbol on the dust collection box (6) to the arrow symbol on the appliance, and pull the dust collection box (6) off the appliance.

- To empty the dust collection box (6). Remove the dust box (6) as step 3 above. Open the dust box (6) by pressing on the release button (7) and pull off the rear part. Remove the dust bag (5). Clean the dust bag (5) thoroughly by tapping it out.

## **CONNECTING/REMOVING THE EXTERNAL DUST EXTRACTION**

- Push the adapter for external dust extraction (3) into the adapter fitting (2).
- Push the hose of a suitable vacuum cleaner on to the adapter for the external dust extraction (3).
- Pull the hose of the vacuum cleaner off the adapter for the external dust extraction (3) and remove the adapter for the external dust extraction (3).

## **OPERATION**

---



**WARNING!** Make sure that the power supply voltage matches the voltage rating indicated on the appliance's type plate.

### **SWITCHING ON/OFF**

- Connect the appliance to the power supply.
- To switch on, push the On/Off switch (3) to position "I". The tool will power on.
- To switch off, push the On/Off switch (3) to position "O". The tool will power off.

### **SETTING THE OSCILLATING SPEED**

You can set the desired oscillating speed by using the speed selector (14) as required.

The required oscillation speed depends on the materials to be processed and can be determined through practical tests.

### **WORKING PROCEDURES**

- Switch the appliance on before applying it to the workpiece.
- Apply minimal pressure when working.
- Work at a constant speed.
- Change the sanding sheets regularly.
- Never use the same sanding sheet for sanding different materials (e.g. wood followed by metal). Optimum sanding results can only be achieved by using clean sanding sheets.
- Clean the sanding sheet every once in a while using a vacuum cleaner.
- Sand hard-to-reach places with the front or side edge of the sanding sheet on the sander plate.
- Guide the sander over the workpiece in parallel and use overlapping sanding motions.
- After completing the task, lift the appliance from the workpiece and then switch it off.

### **SELECTION OF THE SANDING SHEET**

Grain size P	Application
P 60	For pre-sanding rough wood surfaces
P 80 or P 120	For plain sanding
P 240	For fine sanding of primed and painted surfaces

## CLEANING & MAINTENANCE

---



### **WARNING! RISK OF INJURY!**

- Pull the mains plug before any adjustments, maintenance or repair.
- Repair and servicing work not described in this manual should always be carried by the Service Centre. Use only the original parts.
- The following cleaning and servicing should be done regularly. This will ensure a long and reliable service life.
- Do not spray the appliance with water and do not immerse it in water. **Electric Shock** hazard.
- Keep clean the ventilation slots, motor housing and handles of the appliance. Use a damp cloth or a brush. Do not use cleaning agents or solvents. You may otherwise irreparable damage the appliance.
- Clean the sanding sheet with a vacuum cleaner or knock it out.
- The 3-in-1 sander is maintenance free.

## STORAGE AND TRANSPORTATION

---

### **STORAGE**

- Switch off and unplug the appliance before storage.
- Allow the sander to cool down.
- Store the appliance in a dry and secure place well out of reach of children.
- Empty the dust collection box before storing the appliance.

### **TRANSPORT**

Before transporting, observe the followings:

- Switch off and unplug the appliance.
- Allow the product to cool down.
- Put the appliance and accessories into the case.
- Hold the handle of the case for transportation carefully.

## REPLACEMENT PARTS /ACCESSORIES

---



**WARNING! Only use accessories specified in the operating manual. Using the accessories other than those specific in the operating manual may cause a risk of injury. Only get the accessories listed below from the Service Centre.**

## TROUBLESHOOTING

---

### **NOTE**

This appliance is maintenance-free. Never open the appliance. The appliance may only be repaired by an authorised service centre or Customer Service. If one of the faults listed below occurs, note the followings:

- Disconnect the appliance from any power supply.
- Allow the appliance to cool down.

<b>Problem</b>	<b>Possible cause</b>	<b>Error correction</b>
The appliance does not start	Mains voltage missing; Main circuit breaker is tripped	Check the socket, mains cable. Line, mains plug, repairs to be carried out by qualified electrician if necessary, check main circuit breaker.
	ON/OFF switch may be defective	Repair by Service Centre
	Motor faulty	
The appliance works with interruptions	Internal loose contact	Repair by Service Centre
	ON/OFF switch is broken	
Sander plate does not move although the motor is running	Sander plate is not correctly assembled	Install sander plate correctly
Motor is slowing down and stops	Overload through workpiece	Reduce pressure on the sander
		Workpiece unsuitable
Poor sanding performance	Sanding sheet or sander plate unsuitable for the workpiece to be processed	Use a suitable sanding sheet or sander plate
	Worn sanding sheet	Insert a new sanding sheet
	Incorrect speed	Adjust the oscillation rate
Sanding sheet wears down quickly	Sanding sheet unsuitable for the workpiece to be processed	Use a suitable sanding sheet
	Too much pressure applied	Reduce the pressure
	Speed too high	Adjust the oscillation rate

**Note: if your device does not operate correctly after these check, please contact the Service Center.**

## **DISPOSAL**



To help the environment, please dispose of the product properly when it has reached the end of its useful life and not in the household waste. Information on collection points and their opening hours can be obtained from your local authority.

# DECLARATION OF CONFORMITY

---



**Carrefour Marchandises Internationales**  
**93, avenue de Paris**  
**91342 Massy**  
**France**

Herewith we declare that the product

3in1 Sander 200W

Model number: CPO3IN1(DY94281)

**S/N: 20210718130-20210720565**

Is in conformity with the following European Directives

2006/42/EC

2014/30/EU

2011/65/EU & (EU) 2015/863

And the harmonized standards

EN 62841-1 :2015

EN 62841-2-4: 2014

EN 55014-1:2017+A11:2020

EN 55014-2:2015

EN IEC 61000-3-2:2019

EN 61000-3-3:2013+A1 :2019

EN 55014-2:1997/A2:2008

EN 61000-3-2:2014

Manufacturer and name of the authorised representative of the technical documentation

Signature

Place and date:



## WARRANTY

---

The manufacturer guarantees the product against defects in material and workmanship for a period of 2 years from the date of the original purchase. The warranty only applies if the product is for household use. The warranty does not cover breakdowns due to normal wear and tear.

The manufacturer agrees to replace parts identified as defective by the designated distributor. The manufacturer does not accept responsibility for the replacement of the machine, in whole or in part, and/or ensuing damage.

### **The warranty does not cover breakdowns due to:**

- insufficient maintenance.
- abnormal assembly, adjustment or operations of the product.
- parts subject to normal wear and tear.

### **The warranty does not extend to:**

- shipping and packaging costs.
- using the tool for a purpose other than that for which it was designed.
- the use and maintenance of the machine done in a manner not described in the user manual.

Due to our policy of continuous product improvement, we reserve the right to alter or change specifications without notice. Consequently, the product may be different from the information contained therein, but a modification will be undertaken without notice if it is recognized as an improvement of the preceding characteristic.

### **READ THE MANUAL CAREFULLY BEFORE USING THE MACHINE.**

When ordering spare parts, please indicate the part number or code, you can find this in the spare parts list in this manual. Keep the purchase receipt; without it, the warranty is invalid. To help you with your product, we invite you to contact us by phone or via our website:

**+33 (0)9.70.75.30.30**

**<https://services.swap-europe.com/contact>**

You must create a "ticket" via the web platform.

- Register or create your account.
- Indicate the reference of the tool.
- Choose the subject of your request.
- Describe your problem.

Attach these files: invoice or sales receipt, photo of the identification plate (serial number), photo of the part you need (for example: pins on the transformer plug which are broken).



## PRODUCT FAILURE

---

### WHAT TO DO IF MY MACHINE BREAKS DOWN?

#### **If you bought your product in a store:**

- Make sure that your machine is complete with all accessories supplied, and clean! If this is not the case, the repairer will refuse the machine.
- Go to the store with the complete machine and with the receipt or invoice.

#### **If you bought your product on a website:**

- Make sure that your machine is complete with all accessories supplied, and clean! If this is not the case, the repairer will refuse the machine.
- Create a SWAP-Europe service ticket on the site: <https://services.swap-europe.com> When making the request on SWAP-Europe, you must attach the invoice and the photo of the nameplate (serial number).

Contact the repair station to make sure it is available before dropping off the machine.

Go to the repair station with the complete machine packed, accompanied by the purchase invoice and the station support sheet downloadable after the service request is completed on the SWAP-Europe site

**Please keep your original packaging to allow for after-sales service returns or pack your machine with a similar cardboard box of the same dimensions.**

**For any question concerning our after-sales service you can make a request on our website <https://services.swap-europe.com>**

**Our hotline remains available at +33 (9) 70 75 30 30.**



# WARRANTY EXCLUSIONS

---

## THE WARRANTY DOES NOT COVER:

- Start-up and setting up of the product.
- Damage resulting from normal wear and tear of the product.
- Damage resulting from improper use of the product.
- Damage resulting from assembly or start-up not in accordance with the user manual.
- Breakdowns related to carburetion beyond 90 days and fouling of carburetors.
- Periodic and standard maintenance events.
- Actions of modification and dismantling that directly void the warranty.
- Products whose original authentication marking (brand, serial number) has been degraded, altered or withdrawn.
- Replacement of consumables.
- The use of non-original parts.
- Breakage of parts following impacts or projections.
- Accessories breakdowns.
- Defects and their consequences linked to any external cause.
- Loss of components and loss due to insufficient screwing.
- Cutting components and any damage related to the loosening of parts.
- Overload or overheating.
- Poor power supply quality: faulty voltage, voltage error, etc.
- Damages resulting from the deprivation of enjoyment of the product during the time necessary for repairs and more generally the costs related to the immobilization of the product.
- The costs of a second opinion established by a third party following an estimate by a SWAP-Europe repair station
- The use of a product which would show a defect or a breakage which was not the subject of an immediate report and/or repair with the services of SWAP-Europe.
- Deterioration linked to transport and storage\*.
- Launchers beyond 90 days.
- Oil, petrol, grease.
- Damages related to the use of non-compliant fuels or lubricants.

\* In accordance with transport legislation, damage related to transport must be declared to carriers within 48 hours maximum after observation by registered letter with acknowledgement of receipt.

This document is a supplement to your notice, a non-exhaustive list.

**Attention:** all orders must be checked in the presence of the delivery person. In case of refusal by the delivery person, it you must simply refuse the delivery and notify your refusal.

**Reminder:** the reserves do not exclude the notification by registered letter with acknowledgement within 72 hours.

### **Information:**

Thermal devices must be wintered each season (service available on the SWAP-Europe site). Batteries must be charged before being stored.

Staple here your receipt

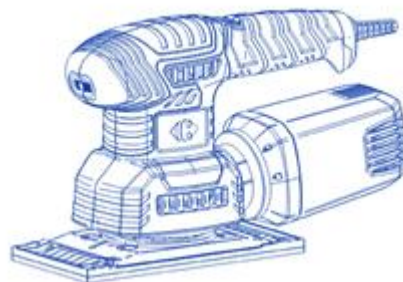

Product	Ref	EAN
3in1 Sander 200W	DY94281	3616474461925



EN

## For any comments or suggestions

Carrefour Consumer service  
– CMI  
TSA 91431  
91343 MASSY Cedex  
France  
[www.carrefour.fr](http://www.carrefour.fr)

 **N°Cristal** 09 69 39 70 00

APPEL NON SURTAXE

More information on  
[www.mycarrefourdocs.com](http://www.mycarrefourdocs.com)